

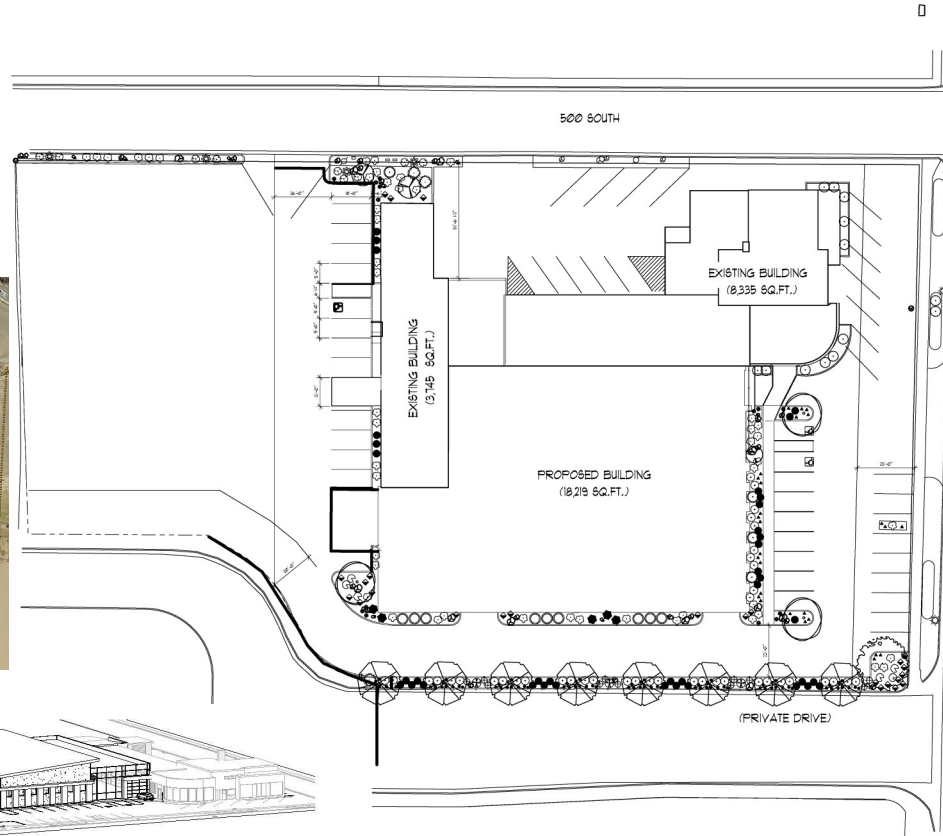

Robarge Addition



- EXISTING TREES/SHRUBS**
 EXISTING TREES - PROTECT IN PLACE (UNLESS DRAWING NOTES DIFFERENTLY)
 EXISTING SHRUBS - PROTECT IN PLACE (UNLESS ARCHITECT NOTES DIFFERENTLY)
 EXISTING SEASONAL PLANTER - PROTECT IN PLACE (UNLESS DRAWING NOTES DIFFERENTLY)
 EXISTING BOLLERS - PROTECT IN PLACE (UNLESS ARCHITECT NOTES DIFFERENTLY)
- PROPOSED TREES**
 TRI-COLOR EUROPEAN BEACH FAGUS SYLVATICA 'TRICOLOR' - 30" TUB (1)
 SINGLE TRUNK UPRIGHT W/ BRANCHES ABOVE GROUND SILVER LINDEN
 TILIA TOMENTOSA 'STERLING SILVER' - 24" BOX (8)
 FULL & BUSHY W/ NO TRUNK DAMAGE SKYLINE HONEYLOCUST
 GLEDITSIA TRI-INERTIS VAR. 'SKYLINE' - 24" BOX (3)
 STRONGLY UPRIGHT W/ NO TRUNK DAMAGE STAGNORUM SUPAC - 3/4" TYPHNA - 24" BOX (2)
 MULTI-TRUNK
- PROPOSED SHRUBS**
 TIGER EYES STAGNORUM SUPAC
 RHUS TYPHNA 'TIGER EYES' - 9 GAL (1)
 YELLOW TIG DOGWOOD
 CORNUS ALBA 'BUCK YELLOW' - 5 GAL (3)
 BUTTERFLY BUSH
 BUECHERIA DAVIDI 'BUZZ HOT RASPBERRY' - 5 GAL (3) FULL
 FEATHER REED GRASS
 CALYPTAGROSTIS ACUTIFLORA 'KARL FORBSTER' - 5 GAL (4)
 HOOK ORANGE
 PHILDEPHAE INDOUBILIT - 5 GAL (3) FULL AND BUSHY
 LOUISIAN COTONEASTER
 COTONEASTER 'LOU FAST' - 5 GAL (3B) FULL AND BUSHY
 BOKWOOD
 BUKA 'GREEN VELVET' - 5 GAL (4D) FULL AND BUSHY
 GOLDFINGER CINQUEFOIL
 POTENTILLA FRUTICOSA 'GOLDFINGER' - 5 GAL (5) FULL
 GOLDEN DEVINE BARSBERY
 BERRERIS 'HANBERG' 'GOLDEN DEVINE' - 5 GAL (6)
 COLOR GUARD YUCCA
 YUCCA FILI-PENTOSA 'COLOR GUARD' - 5 GAL (4)
 PINK SUPREME CAHNET ROSE
 ROSA 'HYBRID' - 3 GAL (1E) FULL AND BUSHY
 BAR HARBOR JUNPER
 JUNIPERUS HORIZONTALIS 'BAR HARBOR' - 5 GAL (4B) FULL
 YUCCA BEARBERRY MANZANTIA
 ANGIOSPERMUS 'COLORADO' 'PANCHITO' - 5 GAL (3)
 FEBRUA OVINA VAR. 'GLAUCO ELIJAH BLUE' - 5 GAL (5)
 ETERNAL PINK CREEPING PINKY
 PINKY BUBULATA 'ETERNAL PINK' - 1 GAL (7) FULL
 BIRCH'S LEED
 ABOPOPHY PODOGRARIA 'VARIEGATUM' - PLANT (4)
 WINTERCREEPER
 BUNYUS FORTUNE 'COLORATA' - 1 GAL (2B) FULL AND BUSHY
 BOLLERS: BOLLERS TO COMPLEMENT ARCHITECTURE
 8" SMALL (10-18") 24" MEDIUM (8'-24") 12" LARGE (24")

LANDSCAPE NOTES
 1. CONTRACTOR TO FIELD VERIFY EXACT SITE DIMENSIONS
 2. CONTRACTOR TO VERIFY EXACT PLANT COUNT

LANDSCAPE PLAN

DATE: 09/20/17
 REVISION:
 1. ALAN P. PULSON
 2. RONALD B. JONES
 3. BRUCE T. FALLEN

WPA ARCHITECTURE

ROBARGE COLLISION ADDITION & REMODEL
 570 South Main Street

L1.1
 LANDSCAPE PLAN

File Name: Robarge Addition
 Applicant: WPA Architecture
 Number of Lots: 1
 Address: 570 South Main Street
 Application Date: 09/11/2017

Site Plan
 1.96 Acres
 File #: 17-001074
 Permit #: SP17-000015
 Application Approved: 10/18/2017